

# Little Hayes

## FISHPONDS

APPROXIMATE FLOOR AREA  
54.4 SQM / 585 SQFT



GROUND FLOOR  
292 sq.ft. (27.2 sq.m.) approx.

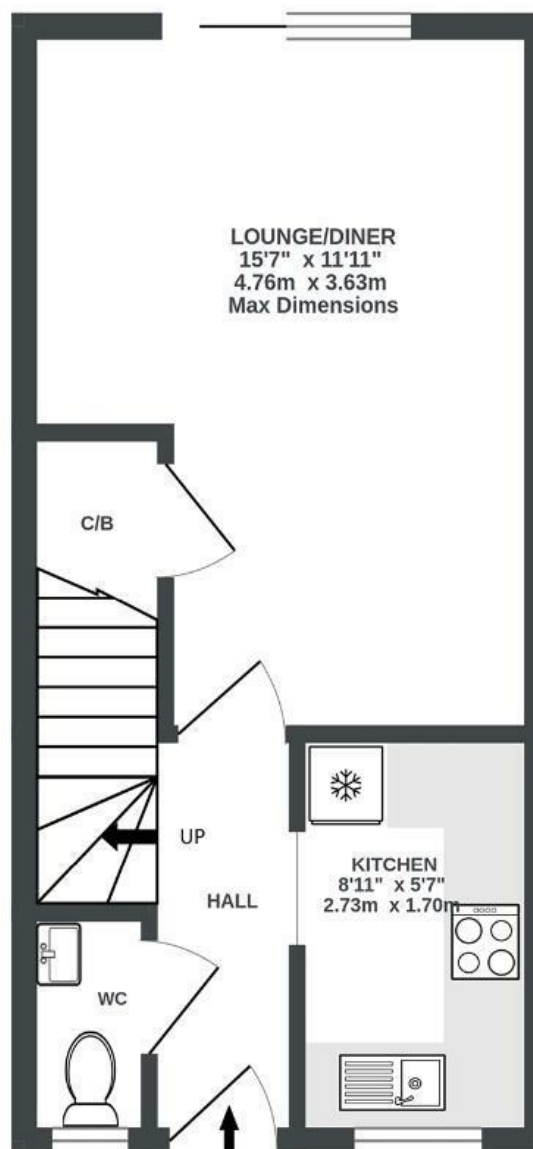

1ST FLOOR  
293 sq.ft. (27.2 sq.m.) approx.

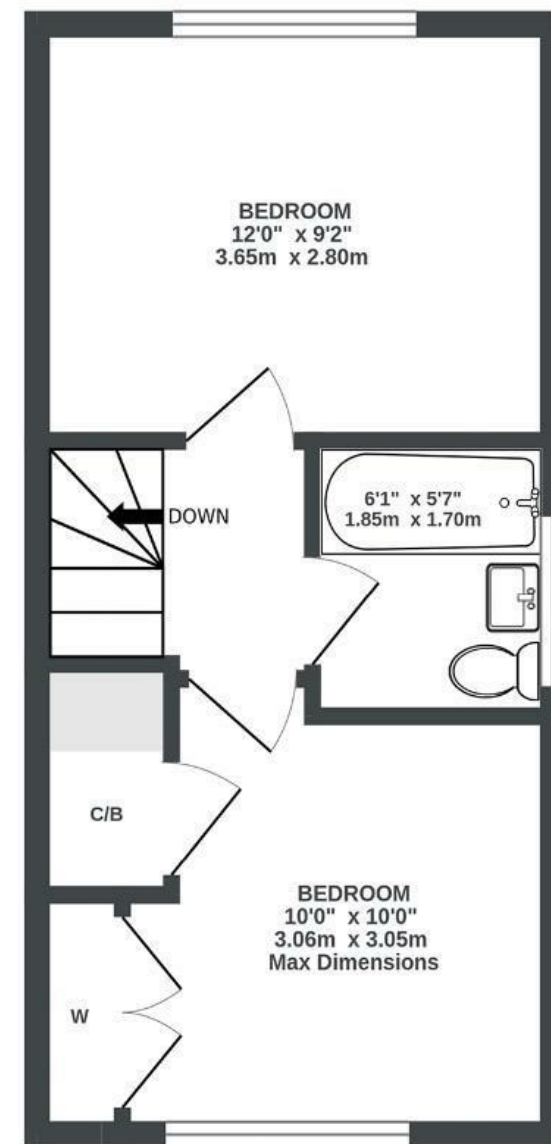

**Boardwalk**

# Little Hayes

FISHPONDS, BRISTOL

£

£325,000

zzz

2 Bedrooms



BS16 2LD



1 Bathrooms

*"Little Hayes is a hidden gem near Oldbury Court Park. It's a quiet area and a lovely neighbourhood. The tranquil garden faces south, with no other houses behind the fence. It's been our first house and we've had the happiest time here. We will miss it so much!"*

